

Special care and OT area



# U-Care

Ergonomics & Safety for a tailor made Caring space



# TLV

Healthcare

# U-Care

This suspended technical beam offers ergonomics & safety to caring staff thanks to its numerous tailor made configurations.

Specific ceiling mounting system for each project

Lighting integration in the beam on request

Travelling crab

Distribution box on swivel arm

Distribution box on travelling crab

Wide range of accessories & trays



Integration of any medical gases outlets standard



Also available without casing



Dust free travelling crab protection

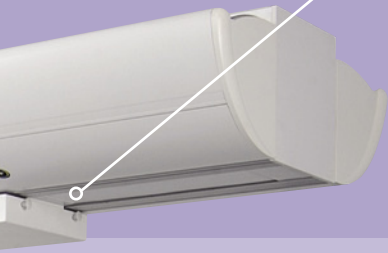

- **U-Care Mobile column / head :** - Travelling crabs standard working range 800 mm
  - Electrical sockets & medical gases outlets integrated in distribution box
- **U-Care Mobile trays :** - Travelling crabs standard working range on total length
  - Electrical sockets & medical gases outlets integrated in the beam

- Complete integration of all cables & hoses in the beam
- Easy cleaning & disinfection thanks to smooth surfaces
- Exclusive patented system preventing hoses pinching
- Travelling crabs & arms rotation lock to avoid any mishandling

- Optimized maintenance thanks to clipped covers (beam & vertical box) or screwed cover (horizontal box)
- Specific & upgradeable solution to any hospital need in full compliance with international norms & standards
- General, reading & caring lightings integrated on request conforming to customer specifications
- Standard components for spare parts availability

Comfort

Safety

Cost  
control

# Choice between Arm, Distribution Boxes or Shuttle...

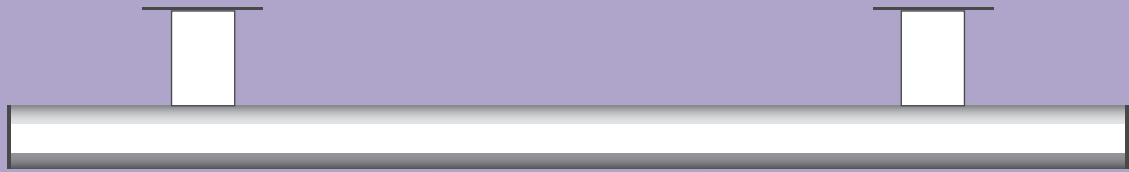

Technical Beam

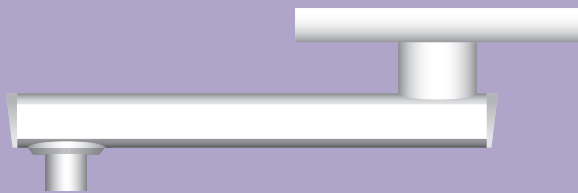

Arm on travelling crab



Travelling crab

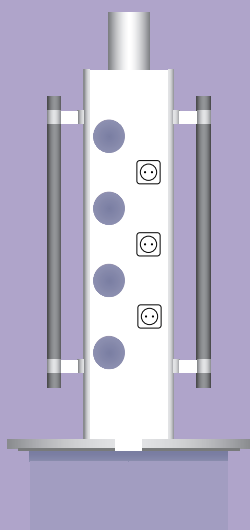
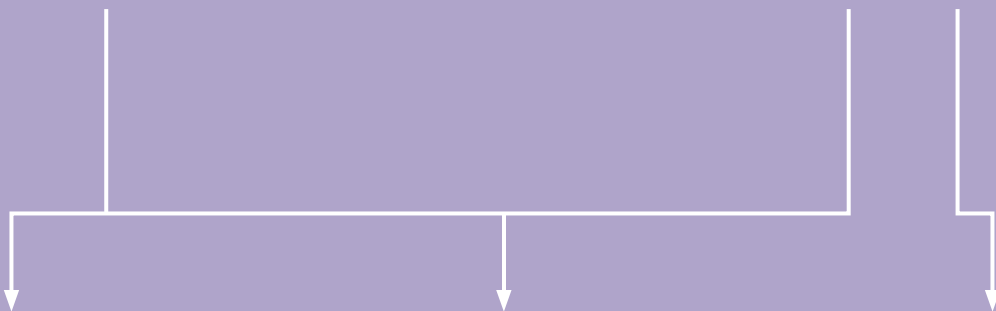

Vertical distribution box

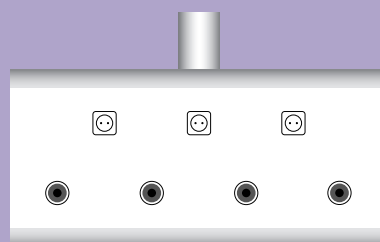

Horizontal distribution box

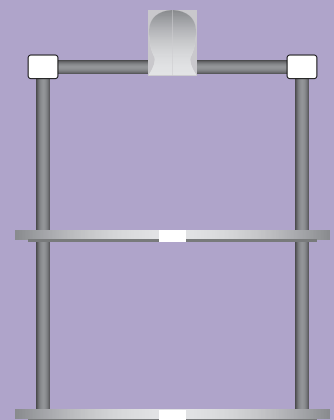

Shuttle

# ...for numerous Tailor Made Ergonomic Configurations



Erasme Hospital - Recovery unit - Brussels (B)



Guimaraes Hospital - Pediatric ICU - Guimaraes (P)



Basurto Hospital - Recovery unit - Bilbao (E)



Basurto Hospital - Recovery unit - Bilbao (E)

## Technical specifications

Ceiling mounting system	Specific study & manufacturing for each project
Technical beam	Tailor made length & functional height
Lightings	General : 2 x 36 W or 58 W STC, HF or dimmable Reading : 1 x 18 W or 2 x 18 W, HF or dimmable Night orientation : 1 x 7 W LC or LED
Travelling crab standard working	800 mm
Payload (*)	Horizontal distribution box : 120 Kg Vertical distribution box : 90 Kg Shuttle : 150 Kg
Colors	RAL 9016 or any others on request
Product classification	Classe II B when products piped in our factory
Medical CE marking	N° 0459 according 93/42/CEE Directive

\* Payload is the weight under the travelling crab fixation point of its arm, distribution box or tray.

### - Electrical equipment

Integration, on request, of any types of electrical sockets, nurse call systems, phone sockets, earthing sockets & other LV and ELV equipments  
 General, reading & night orientation lightings on request  
 Easy connections thanks to «within reach» & safe equipments positioning

### - Medical Gases equipment

Integration of all sockets type DIN, BS, NF  
 Outlets with or without casing  
 International Norms & Standards compliance

### - Equipment & Accessories

Integration of standard rail or tube support,  
 Trays, drawers, ...

## Lighting performances

### General lighting (indirect)

Recommendation : 100 lux  
 U-Care : average 133 lux  
 Source 2 T8 58W

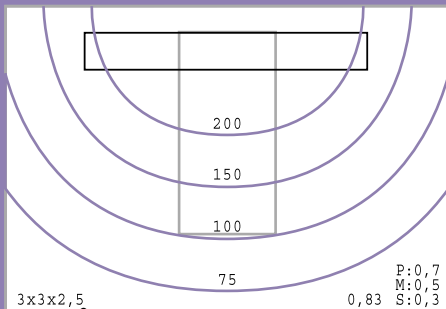

Standard room dimension defined by AFE

### Examination lighting (direct+indirect)

Recommendation : 300 lux  
 U-Care: average 418 lux  
 Source 2 T8 58W + 2 T8 18W

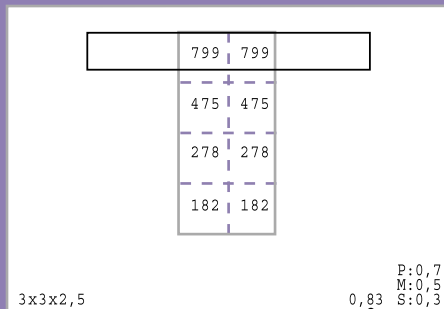

Depreciation coefficient for light sources luminaires wear & diminution of floor, ceiling & walls reflection coefficient

### Reading lighting (direct)

Recommendation : 300 lux  
 U-Care : average 328 lux  
 Source 2 T8 18W

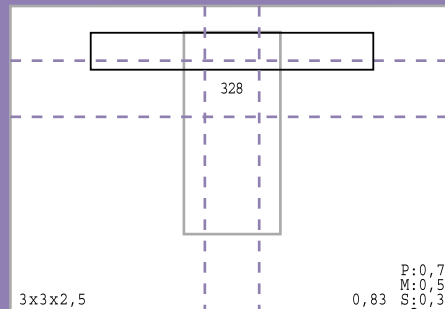

Floor, ceiling & walls reflection coefficient

All specifications are subject to modifications. (B)